

# IMPORTANT SAFEGUARDS

Follow the basic safety precautions

When using electrical appliances, basic safety precautions should always be followed, to reduce the risk of fire, electric shock, and/or injury to persons, including the following:

- Read all instructions.
- To protect against fire, electric shock and injury to persons, do not immerse cord, plugs, or body of machine in water or other liquid.
- Close supervision is necessary when any appliance is used by or near children.
- Unplug from outlet when not in use and before cleaning.
- Do not operate any appliance with a damaged cord or plug or after the appliance malfunctions, or has been damaged in any manner. Return appliance to the nearest authorized service facility for examination, repair or adjustment.
- The use of accessory attachment not recommended by the appliance manufacturer may result in fire, electric shock, or injury to persons.
- Do not use outdoors.
- Do not let the cord hang over the edge of a table or counter, or touch hot surfaces.
- Do not place on or near a hot gas or electric burner, or in a heated oven.
- Always attach plug to appliance first, then plug cord into the wall outlet. To disconnect, turn your Cool Control off then remove plug from wall outlet.

- Do not use appliance for other than intended use.
- For household use only.

## Special cord set instructions

- a. A short power supply cord is provided to reduce the risk resulting from becoming entangled in or tripping over a long cord.
  - b. Longer extension cords are available and may be used if care is exercised in their use.
  - c. If an extension cord is used,
    1. the marked electrical rating of the extension cord should be at least as great as the electrical rating of the appliance, and
    2. if the appliance is of the grounded type, the extension cord should be a grounding type 3-wire cord, and
    3. the longer cord shall be arranged so that it will not drape over the counter top or tabletop where it can be pulled on by children or tripped over.
- If the plug does not fit fully in the outlet, reverse the plug. If it still does not fit, contact a qualified electrician.
  - Do not modify the plug in any way or attempt to defeat this safety feature.

# SAVE THESE INSTRUCTIONS

## Warning

To reduce the risk of fire or electric shock, do not remove any service covers. No user serviceable parts inside. Repair should be done by authorized personnel only.

## Caution

This appliance is for household use. Any servicing other than cleaning and user maintenance should be performed by an authorized service representative:

- Do not immerse base in water or try to disassemble.
- To reduce the risk of fire or electric shock, do not remove the base. No user serviceable parts inside. Repair should be done by authorized service personnel only.
- Check voltage to be sure that the voltage indicated on the name plate agrees with your voltage.
- Keep the cord away from hot parts of the appliance during operation.
- Never clean with scouring powders or hard implements.

**NEVER DO** (or you will void your warranty protection):

- Never do anything with the appliance which is not described in the User's Manual. In case of doubt, call your dealer.

## Cool Control

## Your Cool Control

Symbol description .....	11
<b>Important information</b>	<b>13</b>
Proper use .....	13
For your safety .....	13
<b>1 Preparing and using for the first time</b>	<b>14</b>
Supplied as standard.....	14
Set-up and connection .....	14
Cooling milk .....	14
<b>2 Cleaning and maintenance</b>	<b>15</b>
<b>3 Transport and environmentally neutral disposal</b>	<b>15</b>
Transport.....	15
Disposal.....	15
<b>4 Technical data</b>	<b>15</b>

### Symbol description

Warnings:



#### CAUTION

Always take note of any information marked with the CAUTION or WARNING symbol. The signal word WARNING points out potential risk of serious injury, and the signal word CAUTION potential risk of slight injury.

Symbols used:



**Information** and tips to make things easier for you as you use your Cool Control.



**Prompt to take action.** This symbol means that you are being prompted to perform some action.

## Cool Control

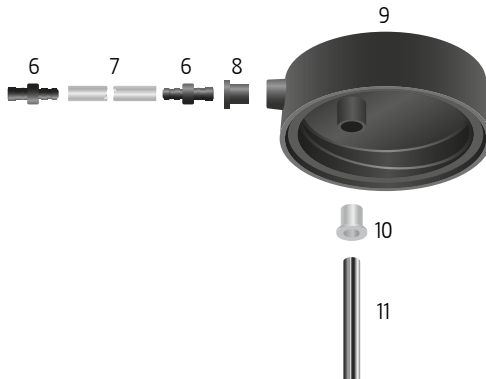

- 1 Cool Control
- 2 Stainless steel container
- 3 Operation indicator lamp
- 4 Power cable with power supply unit
- 5 On/off button
- 6 Connector for milk pipe)

- 7 Milk pipe
- 8 Seal
- 9 Lid
- 10 Metal pipe holder
- 11 Metal pipe

## Important information

### Proper use

The machine was designed and built for domestic use. It was only designed to cool milk in the supplied stainless steel container and keep it fresh. Use for any other purpose will be deemed improper. JURA cannot accept any responsibility for the consequences of improper use.

Keep these Instructions for Use close to the machine and, if appropriate, pass them on to the next user.

### For your safety

Please read and note carefully the following important safety information.

By doing this, you can avoid the life-threatening danger of electric shock:

- Never use a machine which has been damaged or with a defective power cable.
- Never use the machine when you have wet hands.
- Before taking the machine into operation ensure that the supply cable and connector are dry.
- Only connect the machine to the AC mains power with the power supply unit supplied with the machine.
- For information on what to do in case of damage, for example if there is a smell of burning, unplug the machine immediately from the mains supply and contact the JURA service centre.
- If the power cable or the machine is damaged, it must be repaired either directly by JURA or by a JURA approved service centre.
- Make sure that the Cool Control and the power cable are not located close to hot surfaces or naked flames.
- Be careful to ensure that the power cable does not get caught and does not rub against sharp edges.
- Never open and repair the machine yourself. Do not modify the machine in any way that is

not described in the Instructions for Use. The machine contains live parts. Repairs may only be carried out by JURA approved service centres, using original spare parts and accessories.

A defective machine is not safe and could cause injury or fire. To avoid damage and any associated risk of injury or fire:

- Ensure that the ventilation slots are not covered.
- Never allow the power cable to loosely hang down. The power cable can be tripped over or damaged.
- Protect the Cool Control from environmental influences such as rain, frost and direct sunlight.
- Do not put the Cool Control, cable or connections in water.
- Do not put the Cool Control or any individual parts in the dishwasher.
- Turn your Cool Control off and disconnect the mains plug before starting any cleaning operation. Always wipe your Cool Control with a damp cloth rather than a wet one, and protect it from prolonged water splash.
- Do not fill the milk which you wish to cool directly into the machine. Use the stainless steel container supplied as standard.
- Only connect the machine to a power supply in accordance with the technical data (see rating plate and Chapter 4 «Technical data»).
- If you will be absent for an extended period, turn the machine off.
- Do not leave the machine unattended when it is in operation.

The machine is only allowed to be used by people who can use it safely. People, including children, who do not have the

- physical, sensory or mental capabilities or
- experience or knowledge

to use the machine safely must be supervised by a responsible person when using it, or be instructed in how to use it correctly.

## 1 Preparing and using for the first time

This chapter provides you with the information you need to use your Cool Control without any problems. You will prepare your Cool Control step-by-step for its first use.

### Supplied as standard

The following items are supplied as standard:

- JURA Cool Control
- Instructions for Use
- Stainless steel container
- Power supply unit
- Milk pipe (3x)
- Connector for milk pipe (3x)
- Seal, black (2x)
- Metal pipe holder, transparent (2x)
- Metal pipe

### Set-up and connection

When setting up and connecting your Cool Control, please proceed as follows:

- Set the machine down on a horizontal surface that is not sensitive to water.
- Choose a spot for your Cool Control which is protected against overheating.
- Before starting your new machine wipe it carefully on the inside and outside with a damp cloth for reasons of hygiene.

**i** Please consult the **rating plate** on the underside of the Cool Control before connecting the machine.

---

### WARNING

If the machine is operated with a defective power cable, there is a danger of electric shock.

- ▶ Never use a machine which has a defective power cable.

- 
- ▶ Connect the cable of the power supply unit to the machine.
  - ▶ Insert the mains plug into a power socket.

- ▶ Fit the transparent metal pipe holder onto the side of the metal tube which is not angled.

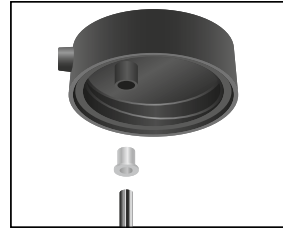

- ▶ Connect this side with the opening provided for this purpose in the lid of the stainless steel container.
- ▶ Fit both connectors onto the milk pipe.

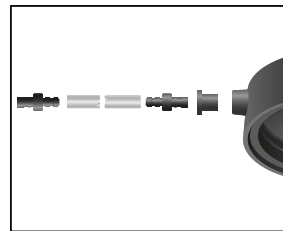

- ▶ Fit the black seal onto one side of the milk pipe.
- ▶ Use the seal to connect the milk pipe to the opening on the outside of the lid.

### Cooling milk

- ▶ Fill the stainless steel container with milk.
- ▶ Close the stainless steel container with the lid.
- ▶ Place the stainless steel container into the Cool Control.
- ▶ Connect the milk pipe to the nozzle on your JURA fully automatic coffee machine.
- ▶ Press the On/Off button.  
The operation indicator lamp lights up and the machine starts to cool the milk.

**i** The machine switches off automatically during cooling. Your JURA Cool Control always keeps the temperature of the milk in the optimum range. The milk cannot freeze.

- i** If you want to stop cooling, press the On/Off button.
- i** When you take the machine out of operation, disconnect the mains plug from the socket.

## 2 Cleaning and maintenance

- i** Do not use any sharp, corrosive or abrasive cleaning agents or hard objects for cleaning. These could damage the machine, the coating on the stainless steel container holder and the stainless steel container.
  - ▶ Before cleaning the machine disconnect the mains plug from the power socket.
  - ▶ Wipe the inside of the machine with a damp cloth.
  - ▶ Wipe the outside of the machine with a damp cloth.
  - ▶ Rinse the stainless steel container and the individual parts thoroughly with running water.

## 3 Transport and environmentally neutral disposal

### Transport

Keep the packaging of your Cool Control. It should be used to protect the machine during transportation.

Clean the stainless steel container before transport.

### Disposal

Please dispose of old machines in an environmentally neutral way.



Old machines contain valuable materials capable of being recycled which should be salvaged for recycling. Please therefore dispose of old machines via suitable collection systems.

## 4 Technical data











- i** The voltage and current **vary** according to the safety test. Please observe the **rating plate** before connecting the machine.

The rating plate is located on the bottom of your Cool Control. The information shown on this should be interpreted as follows:

- V AC = alternating current in volts
  - W = power output in watts
- Ⓒ This product complies with all applicable EU directives.
  - Ⓖ This product complies with all applicable GS directives (Tested Safety).
  - Ⓛ This product complies with all applicable UL directives (Underwriters Laboratories Inc.®).
  - Ⓒ This product complies with all applicable SAA directives (Standards Association of Australia).
  - Ⓒ This product complies with all applicable CCC directives (China Compulsory Certification).
  - Ⓖ This product complies with all applicable PSE directives (Electrical Appliance And Material Safety Law).
  - Ⓖ This product complies with all applicable EK directives.



## Cool Control

Voltage	 230 V AC, 50 Hz  120 V AC, 60 Hz  220 – 240 V AC, 50 Hz  220 V AC, 50 Hz  100 V AC, 50 Hz or 60 Hz  220 V AC, 50 Hz
Safety test	    
Power	20 W
Cooling	Non-wearing and CFC-free Peltier cooling with heat discharge by a fan
Temperature range	Cools to 25°C below ambient temperature, but not below 4°C
Weight	ca. 1.5 kg
Holding capacity of stainless steel container	1.0 l
Cable length	1.8 m
Dimensions (W x H x D)	15 x 21 x 21 cm

## Directives

The machine complies with the following EU directives:

- 73/23/EEC of 19 February 1973, Low Voltage Directive including Amending Directive 93/68/EEC.
- 89/336/EEC of 3 May 1989, Electromagnetic Compatibility, incl. Amending Directive 92/31/EEC.

## Technical changes

We reserve the right to make technical changes.

## Feedback

Your opinion is important to us!

Use the contact link at [www.jura.com](http://www.jura.com).

The Instructions for Use contain information which is protected by copyright. It is not permitted to photocopy or translate these Instructions for Use into another language without the express written consent of JURA Elektroapparate AG.

JURA Elektroapparate AG  
Kaffeeweltstraße 10  
CH-4626 Niederbuchsiten

[www.jura.com](http://www.jura.com)